

lm

learning matters
- batterie -

vue d'ensemble

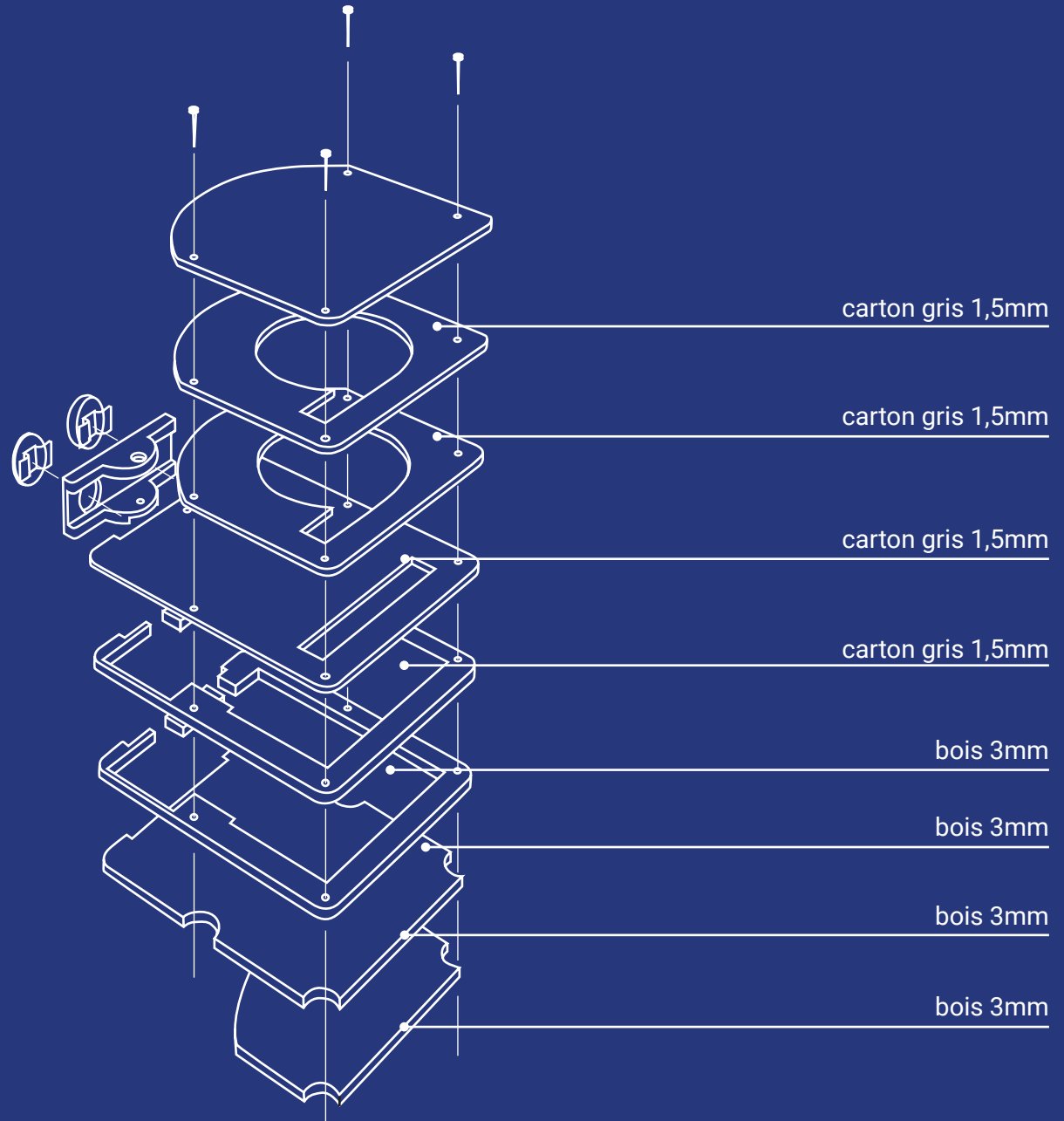

circuit électronique

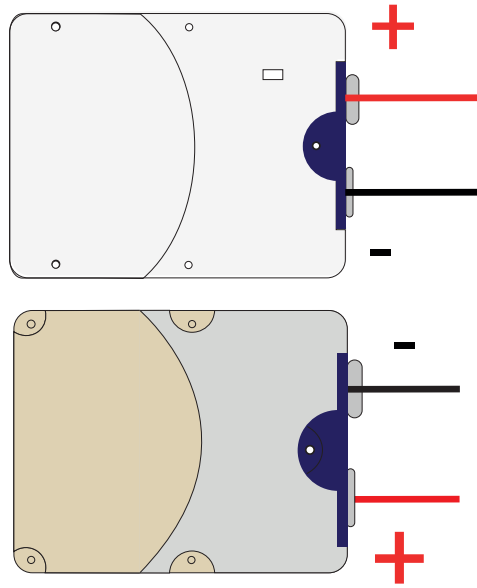

3

(1) **recouvrir** le socle à l'aide du carton gris et placer le chargeur dessus

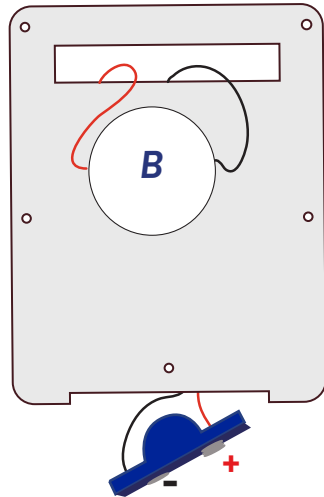

1

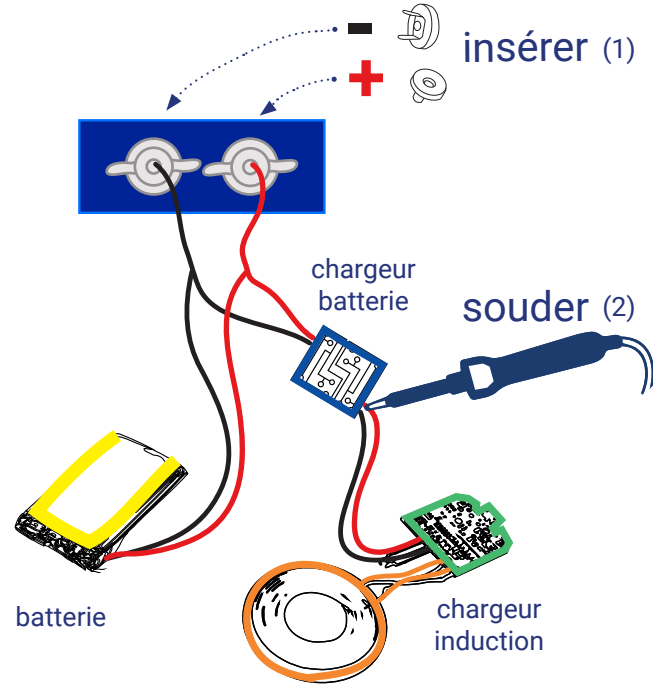

4

(2) **coller**
1 sur 2 sur 3

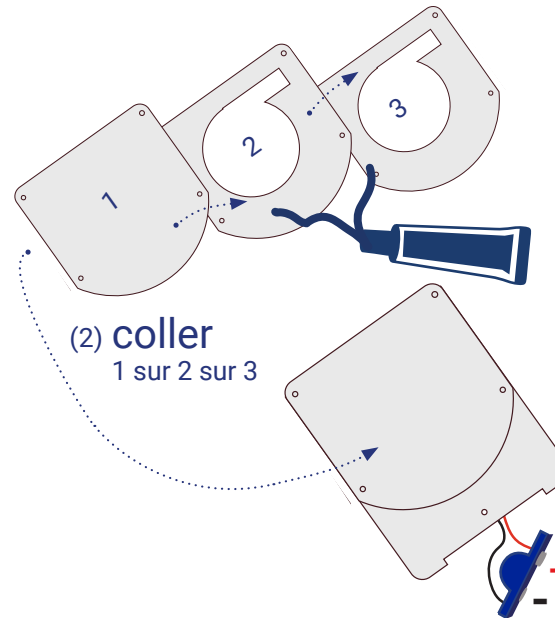

2

placer les éléments dans le socle et laisser le chargeur dépasser

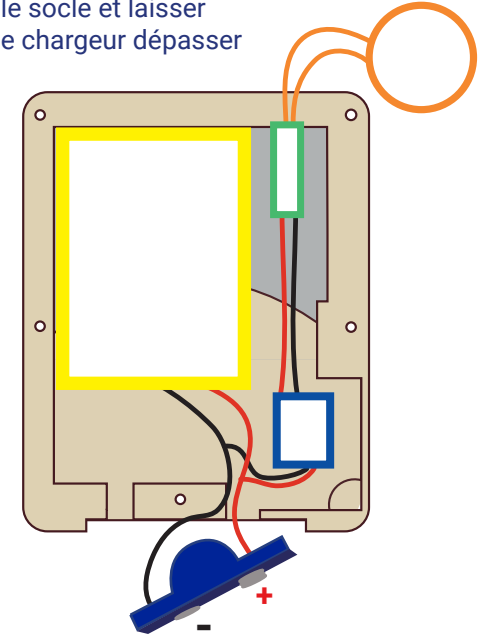

5

(1) **clipser** le connecteur bleu

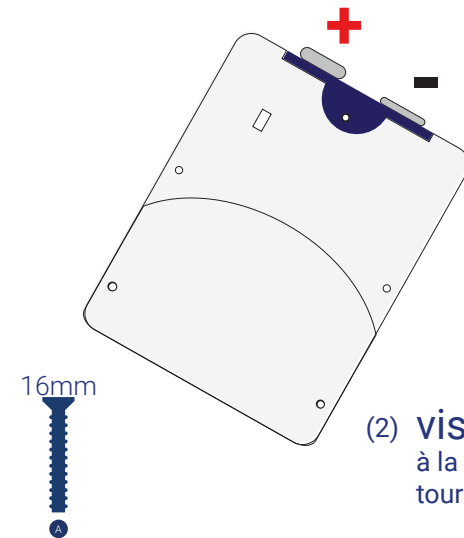

(2) **visser** à la main puis au tournevis étoile

